



## **BIGGS & MATHEWS ENVIRONMENTAL**

*Consulting Engineers ♦ Hydrogeologists*

Mansfield ♦ Wichita Falls

March 31, 2015

Mr. Frank Zeng, Project Manager  
Municipal Solid Waste Permits Section (MC-124)  
Texas Commission on Environmental Quality  
P.O. Box 13087  
Austin, TX 78711-3087

Re: Waste Management Skyline Landfill – Dallas and Ellis Counties  
Municipal Solid Waste (MSW) Permit No. 42D  
Permit Amendment Application – Supplemental Submittal  
Tracking Nos. 15821429, 16078600, and 18430503; RN100542232/CN603572132

Dear Mr. Zeng:

This supplemental submittal is provided on behalf of Waste Management Skyline Landfill. The Land Owners List and Land Ownership Maps included in the permit amendment application in Appendix IB – Land Ownership Map and Land Owners List have been updated to reflect property ownership as of March 26, 2015. Also provided is a copy of the Land Owners List formatted for mailing, previously provided electronically via email on March 30, 2015. One original and three copies are enclosed with this letter.

We trust this submittal is satisfactory to you and meets the regulations of the TCEQ. If you need additional information, please let us know.

Sincerely,

BIGGS & MATHEWS ENVIRONMENTAL  
TBPE No. F-256 ♦ TBPG No. 50222

Kenneth J. Welch, P.E.  
Principal Engineer

Attachments: Land Owners List – Mail Form  
Part I Form - pages 1, 2, and 10  
Land Owners List – pages IB-1 through IB-12  
Land Ownership Maps – pages IB.1 through IB.3

cc: Mr. Steve Jacobs, Waste Management of Texas, Inc.

**SKYLINE LANDFILL  
CITY OF FERRIS  
DALLAS AND ELLIS COUNTIES, TEXAS  
TCEQ PERMIT APPLICATION NO. MSW 42D**

**PERMIT AMENDMENT APPLICATION**

Prepared for

**Waste Management of Texas, Inc.**

April 2012  
Revised August 2012  
Revised July 2014  
Revised January 2015  
Revised February 2015

Revised March 2015



Prepared by

**BIGGS & MATHEWS ENVIRONMENTAL**

1700 Robert Road, Suite 100 ♦ Mansfield, Texas 76063 ♦ 817-563-1144

TEXAS BOARD OF PROFESSIONAL ENGINEERS  
FIRM REGISTRATION No. F-256

TEXAS BOARD OF PROFESSIONAL GEOSCIENTISTS  
FIRM REGISTRATION No. 50222

**SKYLINE LANDFILL  
CITY OF FERRIS  
DALLAS AND ELLIS COUNTIES, TEXAS  
TCEQ PERMIT APPLICATION NO. MSW 42D**

**PERMIT AMENDMENT APPLICATION**

**VOLUME 1 OF 5**

Prepared for

**Waste Management of Texas, Inc.**

April 2012  
Revised August 2012  
Revised July 2014  
Revised January 2015  
Revised February 2015

Revised March 2015



Prepared by

**BIGGS & MATHEWS ENVIRONMENTAL**

1700 Robert Road, Suite 100 ♦ Mansfield, Texas 76063 ♦ 817-563-1144

TEXAS BOARD OF PROFESSIONAL ENGINEERS  
FIRM REGISTRATION No. F-256

TEXAS BOARD OF PROFESSIONAL GEOSCIENTISTS  
Firm Registration No. 50222

**SKYLINE LANDFILL  
CITY OF FERRIS  
DALLAS AND ELLIS COUNTIES, TEXAS  
TCEQ PERMIT APPLICATION NO. MSW 42D**

**PERMIT AMENDMENT APPLICATION**

**VOLUME 1 OF 5**

**CONTENTS**

---

**MASTER TABLE OF CONTENTS**

**TCEQ PART I FORM**

**TCEQ CORE DATA FORM**

**PART I SITE AND APPLICANT INFORMATION**

**PART II EXISTING CONDITIONS AND CHARACTER OF THE FACILITY  
AND SURROUNDING AREA**



**Biggs & Mathews Environmental, Inc.**  
Firm Registration No. F-256

**SKYLINE LANDFILL  
DALLAS AND ELLIS COUNTIES, TEXAS  
TCEQ PERMIT APPLICATION NO. MSW 42D  
APPLICATION TABLE OF CONTENTS**

**CONTENTS**

---

**VOLUME 1**

**COVER LETTER**

**TCEQ PART I FORM**

**TCEQ CORE DATA FORM**

**PART I – SITE AND APPLICANT INFORMATION**

1	GENERAL .....	I-1
2	FACILITY LOCATION .....	I-5
3	MAPS .....	I-6
4	PROPERTY OWNER INFORMATION .....	I-7
5	LEGAL AUTHORITY .....	I-9
6	EVIDENCE OF COMPETENCY .....	I-10
7	APPOINTMENTS .....	I-16
8	APPLICATION FEES .....	I-17

APPENDIX IA – GENERAL LOCATION MAPS

APPENDIX IB – LAND OWNERSHIP MAP AND LAND OWNERS LIST

APPENDIX IC – LEGAL DESCRIPTION AND PERMIT BOUNDARY MAP

APPENDIX ID – LEGAL AUTHORITY

APPENDIX IE – APPOINTMENTS/ACKNOWLEDGEMENTS

APPENDIX IF – DOCUMENTATION OF APPLICATION FEE PAYMENT

**PART II – EXISTING CONDITIONS AND CHARACTER OF THE FACILITY  
AND SURROUNDING AREA**

1	EXISTING CONDITIONS SUMMARY .....	II-1
2	WASTE ACCEPTANCE PLAN .....	II-3
3	GENERAL LOCATION MAPS .....	II-6
4	FACILITY LAYOUT MAPS .....	II-7



Biggs & Mathews Environmental, Inc.  
Firm Registration No. F-256

**TCEQ PART I FORM**



# Texas Commission on Environmental Quality

## Permit or Registration Application for Municipal Solid Waste Facility

### Part I

#### A. General Information

Facility Name:	Skyline Landfill			
Physical or Street Address (if available):	1201 North Central St			
(City) (County)( State)( Zip Code):	Ferris	Ellis	TX	75125-2101
(Area Code) Telephone Number:	972-842-5710			
Charter Number:	22300000			

If the application is submitted on behalf of a corporation, provide the Charter Number as recorded with the Office of the Secretary of State for Texas.

Operator Name <sup>1</sup> :	Waste Management of Texas, Inc.			
Mailing Address:	1201 North Central St			
(City) (County)( State)( Zip Code):	Ferris	Ellis	TX	75125-2101
(Area Code) Telephone Number:	972-842-5710			
(Area Code) FAX Number:	972-842-5873			
Charter Number:	22300000			

If the permittee is the same as the operator, type "Same as Operator".

Permittee Name:	Same as Operator			
Physical or Street Address (if available):				
(City) (County)( State)( Zip Code):				
(Area Code) Telephone Number:				
Charter Number:				

If the application is submitted by a corporation or by a person residing out of state, the applicant must register an Agent in Service or Agent of Service with the Texas Secretary of State's office and provide a complete mailing address for the agent. The agent must be a Texas resident.

Agent Name:	Steve Jacobs			
Mailing Address:	9708 Giles Rd.			
(City) (County)( State)( Zip Code):	Austin	Travis	TX	78754
(Area Code) Telephone Number:	512-272-6245			
(Area Code) FAX Number:	512-272-6289			

#### Application Type:

<input checked="" type="checkbox"/>	Permit	<input checked="" type="checkbox"/>	Major Amendment	<input type="checkbox"/>	Minor Amendment
<input type="checkbox"/>	Registration	<input type="checkbox"/>	Modification	<input type="checkbox"/>	Temporary Authorization
		<input checked="" type="checkbox"/>	w/Public Notice	<input type="checkbox"/>	Notice of Deficiency Response
		<input type="checkbox"/>	w/out Public Notice	<input checked="" type="checkbox"/>	Supplemental Submittal

<sup>1</sup> The operator has the duty to submit an application if the facility is owned by one person and operated by another [30 TAC 305.43(b)]. The permit will specify the operator and the owner who is listed on this application [Section 361.087 Texas Health and Safety Code].

Facility Classification:

<input checked="" type="checkbox"/> Type I	<input type="checkbox"/> Type IV	<input type="checkbox"/> Type V	<input type="checkbox"/> Type IX
<input type="checkbox"/> Type I AE	<input type="checkbox"/> Type IV AE	<input type="checkbox"/> Type VI	

Activities covered by this application (check all that apply):

<input checked="" type="checkbox"/> Storage	<input checked="" type="checkbox"/> Processing	<input checked="" type="checkbox"/> Disposal
---	--	--

Waste management units covered by this application (check all that apply):

<input type="checkbox"/> Containers	<input type="checkbox"/> Tanks	<input type="checkbox"/> Surface Impoundments	<input checked="" type="checkbox"/> Landfills
<input type="checkbox"/> Incinerators	<input type="checkbox"/> Composting	<input type="checkbox"/> Type IV Demonstration Unit	<input type="checkbox"/> Type IX Energy/ Material Recovery
<input checked="" type="checkbox"/> Other (Specify)	Citizen's Convenience Center	<input checked="" type="checkbox"/> Other (Specify)	Leachate Storage Facility
<input checked="" type="checkbox"/> Other (Specify)	Mud Grate Facility	<input checked="" type="checkbox"/> Other (Specify)	Large Item Storage Area
<input checked="" type="checkbox"/> Other (Specify)	Construction & Demolition Recycling & Re-use Area	<input checked="" type="checkbox"/> Other (Specify)	Liquid Stabilization Area
<input checked="" type="checkbox"/> Other (Specify)	Bioremediation Treatment Pad		

Is this submittal part of a Consolidated Permit Processing request, in accordance with 30 TAC Chapter 33?

Yes  No

If yes, state the other TCEQ program authorizations requested.

Provide a brief description of the portion of the facility covered by this application. For amendments, modifications, and temporary authorizations, provide a brief description of the exact changes to the permit or registration conditions and supporting documents referenced by the permit or registration. Also, provide an explanation of why the amendment, modification, or temporary authorization is requested.

Permit amendment application for a horizontal expansion at the existing Skyline Landfill to provide long-term waste disposal capacity for the individuals, businesses, and communities in Dallas and Ellis counties in Texas and other surrounding areas.

Does the application contain confidential Material?  Yes  No

If yes, cross-reference the confidential material *throughout the application* and submit as a separate document or binder conspicuously marked "CONFIDENTIAL."

Alternative Language Notice Instructions

For certain permit applications, public notice in an alternate language is required. If an elementary school or middle school nearest to the facility offers a bilingual program, notice may be required to be published in an alternative language. The Texas Education Code, upon which the TCEQ alternative language notice requirements are based, trigger a bilingual education program to apply to an entire school district should the requisite alternative language speaking student population exist. However, there may not exist any bilingual students at a particular school within a district which is required to offer the bilingual education program. For this reason, the requirement to publish notice in an alternative language is triggered if the nearest elementary or middle school, as a part of a larger school district, is required to make a bilingual education program available to qualifying students and either the school has students enrolled at such a program on-site, or has students who attend such a program at another location in satisfaction of the school's obligation to provide such a program as a member of a triggered district.

If it is determined that an alternative language notice is required, the applicant is responsible for ensuring that the publication in the alternate language is complete and accurate in that language. Electronic versions of the Spanish template examples are available from the TCEQ to help the applicant complete the publication in the alternative language.



Signature Page

I, Steve Jacobs  
(Operator)

Director of Disposal Operations  
(Title)

certify under penalty of law that this document and all attachments were prepared under my direction or supervision in accordance with a system designed to assure that qualified personnel properly gather and evaluate the information submitted. Based on my inquiry of the person or persons who manage the system, or those persons directly responsible for gathering the information, the information submitted is, to the best of my knowledge and belief, true, accurate, and complete. I am aware there are significant penalties for submitting false information, including the possibility of fine and imprisonment for knowing violations.

Signature: [Handwritten Signature]

Date: 3-31-15

-----  
TO BE COMPLETED BY THE OPERATOR IF THE APPLICATION IS SIGNED BY AN AUTHORIZED REPRESENTATIVE FOR THE OPERATOR

I, \_\_\_\_\_, hereby designate \_\_\_\_\_  
(Print or Type Operator Name) (Print or Type Representative Name)

as my representative and hereby authorize said representative to sign any application, submit additional information as may be requested by the Commission; and/or appear for me at any hearing or before the Texas Commission on Environmental Quality in conjunction with this request for a Texas Water Code or Texas Solid Waste Disposal Act permit. I further understand that I am responsible for the contents of this application, for oral statements given by my authorized representative in support of the application, and for compliance with the terms and conditions of any permit which might be issued based upon this application.

Not applicable  
Printed or Typed Name of Operator or Principal Executive Officer

Not applicable when the owner and operator are the same entity.  
Signature

-----  
SUBSCRIBED AND SWORN to before me by the said Steve Jacobs

On this 31<sup>st</sup> day of March, 2015.

My commission expires on the 8<sup>th</sup> day of June, 2015



Janet M. Fulk  
Notary Public in and for

State of County, Texas

(Note: Application Must Bear Signature & Seal of Notary Public)

**SKYLINE LANDFILL  
CITY OF FERRIS  
DALLAS AND ELLIS COUNTIES, TEXAS  
TCEQ PERMIT NO. MSW 42D**

**PERMIT AMENDMENT APPLICATION**

**PART I  
SITE AND APPLICANT INFORMATION**

Prepared for

**Waste Management of Texas, Inc.**

April 2012  
Revised August 2012  
Revised July 2014  
Revised January 2015

Revised March 2015



Prepared by

**BIGGS & MATHEWS ENVIRONMENTAL**

1700 Robert Road, Suite 100 ♦ Mansfield, Texas 76063 ♦ 817-563-1144

TEXAS BOARD OF PROFESSIONAL ENGINEERS  
FIRM REGISTRATION No. F-256

TEXAS BOARD OF PROFESSIONAL GEOSCIENTISTS  
FIRM REGISTRATION No. 50222



**CONTENTS**

---

**1 GENERAL.....I-1**

    1.1 Permit History ..... I-1

    1.2 Supplementary Technical Report ..... I-2

**2 FACILITY LOCATION.....I-5**

    2.1 Location Description ..... I-5

    2.2 Access Routes ..... I-5

    2.3 Geographic Coordinates ..... I-5

**3 MAPS.....I-6**

    3.1 General Location Maps ..... I-6

    3.2 Land Ownership Map and Land Owners List..... I-6

**4 PROPERTY OWNER INFORMATION .....I-7**

    4.1 Legal Description ..... I-7

    4.2 Drainage, Pipeline, and Utility Easements..... I-7

    4.3 Property Owner Affidavit ..... I-8

**5 LEGAL AUTHORITY .....I-9**

**6 EVIDENCE OF COMPETENCY .....I-10**

    6.1 Solid Waste Sites..... I-10

        6.1.1 Texas Facilities..... I-10

        6.1.2 Other Facilities..... I-13

    6.2 Management and Personnel ..... I-13

    6.3 Equipment Dedicated to the Skyline Landfill ..... I-14

**7 APPOINTMENTS .....I-16**

**8 APPLICATION FEES .....I-17**



Biggs & Mathews Environmental, Inc.  
Firm Registration No. F-256

## **CONTENTS (Continued)**

---

**APPENDIX IA – GENERAL LOCATION MAPS**

**APPENDIX IB – LAND OWNERSHIP MAP AND LAND OWNERS LIST**

**APPENDIX IC – LEGAL DESCRIPTION AND PERMIT BOUNDARY MAP**

**APPENDIX ID – LEGAL AUTHORITY**

**APPENDIX IE – APPOINTMENTS/ACKNOWLEDGEMENTS**

**APPENDIX IF – DOCUMENTATION OF APPLICATION FEE PAYMENT**

**SKYLINE LANDFILL**

**APPENDIX IB**

**LAND OWNERSHIP MAP AND LAND OWNERS LIST**

**Skyline Landfill  
Land Owners List**

(From Appraisal District Records for Dallas and Ellis County – March 26, 2015)

1	Waste Management of TX, Inc.	PO Box 276	Lewisville	TX	75067-0276
2	Kenneth Johnson	PO Box 375	Ferris	TX	75125-0375
3	Aldersgate Church	5500 Sayle St	Greenville	TX	75402-6324
4	John Stephens	1911 Williams Rd	Irving	TX	75060-3362
5	Hector C. & Minerva Perez	2614 Sleepy Hollow Ln	Lancaster	TX	75146-5900
6	Eleno Padierna	3314 Linkwood Dr	Lancaster	TX	75146-5908
7	Veronica Stewart	3418 Linkwood Dr	Lancaster	TX	75146-5909
8	James W. Stewart	3420 Linkwood Dr	Lancaster	TX	75146-5909
9	Enrique Martinez	814 S Clinton Ave	Dallas	TX	75208-5923
10	Rafael Silva	125 Summerall Ln	Red Oak	TX	75154-7209
11	Sabrina Huff	3427 Linkwood Dr.	Lancaster	TX	75146-5911
12	Hamid Rahmani	6102 Tiffany Oaks Ln	Arlington	TX	76016-2030
13	Estate of Sarah Hayden c/o Charles Edward Jones	1539 Southerland Ave	Dallas	TX	75203-4336
14	Sassin Investments, Inc.	PO Box 266	Wilmer	TX	75122-0266
15	Sassin and Sons	PO Box 266	Wilmer	TX	75122-0266
16	E. L. Smith III et al c/o Smith Trust Agency	3838 Oak Lawn Ave Ste 1525	Dallas	TX	75219-4527
17	TX Utilities Electric Company	PO Box 219071	Dallas	TX	75221-9071
18	Union Pacific Railroad c/o Tax Department	1400 Douglas St Stop 1640	Omaha	NE	68179-1001
19	Prime Rail Interest LLC	6228 Colleyville Blvd Ste A	Colleyville	TX	76034-6223

**Skyline Landfill  
Land Owners List**

(From Appraisal District Records for Dallas and Ellis County – March 26, 2015)

20	City of Ferris	100 Town Plaza	Ferris	TX	75125-2537
21	Ferris ISD	PO Box 428	Ferris	TX	75125-0428
22	Old Brickyard Group LLC	605 N. Interstate Hwy 45	Ferris	TX	75125-1826
23	Eldridge W & Carla Hoffman	411 Webb St	Ferris	TX	75125-1730
24	Daniel S. & Nadine E. Thursby	415 Webb St	Ferris	TX	75125-1730
25	Juana Gandarilla	408 E. First St	Ferris	TX	75125-1725
26	Melvin Ray Kannady	410 N. Baker St	Ferris	TX	75125-1712
27	Arturo M Garcia & Maribel P. Hernandez	106 East 1 <sup>st</sup> St	Ferris	TX	75125
28	Sergio Salano	7225 W. Flower St	Phoenix	AZ	85033
29	Raymond Caldwell	409 N. Baker St	Ferris	TX	75125
30	Estate of John Ovalle & Victor Garcia	1805 Lakeview Dr	Grand Prairie	TX	75051-5551
31	Emilia Perez	163B Alvis Ln	Ferris	TX	75125
32	Monica Moreno	309 N Main	Ferris	TX	75125-1633
33	Jaime Garcia	411 N. Main St	Ferris	TX	75125
34	Jesus & Amelia De La Rosa	700 A D Mosley St	Ferris	TX	75125-1545
35	Ellis County Trustee	101 W. Main St	Waxahachie	TX	75165-0405
36	Beatrice Moffitt	207 W. Second St	Ferris	TX	75125-1606
37	Michael D. Johnson	211 W 2 <sup>nd</sup> St	Ferris	TX	75125-1606
38	Maria G. Garcia	101 E 4 <sup>th</sup> St	Ferris	TX	75125-2107

**Skyline Landfill  
Land Owners List  
(From Appraisal District Records for Dallas and Ellis County – March 26, 2015)**

39	Monica Moreno & Cleotilde Moreno	309 N Main St	Ferris	TX	75125-1633
40	Jesus & Lilia Orozco	2921 Holy Cross Ln	Garland	TX	75044-4673
41	George A. Ross	3804 Black Oak Dr	Dallas	TX	75241
42	W. W. Wright Estate % Jean Wright Daugherty	8544 Foxwood Ln	Dallas	TX	75217
43	Robert K. & Ofelia Grass	1375 FM 1389 N	Combine	TX	75159
44	Moises Abel & Martha Rojas	2822 McKinney Dr	Lancaster	TX	75134
45	Ophelia Johnson	515 N. Main St	Ferris	TX	75125
46	Lonnie R. & Evelyn M. Mitchell	PO Box 32	Ferris	TX	75125
47	Morris G. Magness	PO Box 205	Ferris	TX	75125
48	ONCOR Electric Delivery c/o State & Local Tax Dept.	PO Box 219071	Dallas	TX	75221-9071
49	Pinkie Yeldell	PO Box 150	Ferris	TX	75125
50	Housing Authority of City of Ferris	PO Box 272	Ferris	TX	75125
51	Maurice Banuelos	309 Adams St	Wilmer	TX	75172
52	Greater Lighthouse Church of God in Christ	PO Box 305	Ferris	TX	75125-0305
53	Ruben Mendez & Olivia Garcia	607 N Wood St	Ferris	TX	75125
54	Community Services, Inc.	PO Box 612	Corsicana	TX	75151
55	Maria Lopez	307 Ave A	Ferris	TX	75125
56	Delorice Pates	311 Ave A	Ferris	TX	75125
57	Hilario Moreno	518 N. Wood St	Ferris	TX	75125



**Skyline Landfill  
Land Owners List**  
(From Appraisal District Records for Dallas and Ellis County – March 26, 2015)

58	Martin & Maria Mendez	607 A D Mosley St	Ferris	TX	75125-1542
59	Jason P. & Theresa M. Smithey	3161 FM 1446	Wahahachie	TX	75167
60	Jose Ozuna	307 W. First St	Ferris	TX	75125
61	Esperanza Gonzales	311 W. First St	Ferris	TX	75125
62	Marciano Romero	410 N. Wood St	Ferris	TX	75125
63	Marietta B. Allen	1601 FM 983	Ferris	TX	75125
64	Mario N. Rivas, Jr.	1011 Mars Rd	Wilmer	TX	75172
65	Howard L. & Kay E Wickliffe	2203 Melissa Dr	Palestine	TX	75803
66	Hermila & Nicolas Barajas	PO Box 1615	Red Oak	TX	75154
67	Arcadio Garza	200 Jennie Marie Circle	Ferris	TX	75125-4021
68	Manuel & Leticia Hernandez	406 N. Wood St	Ferris	TX	75125
69	Augustina C. Luna	405 N. Wood St	Ferris	TX	75125
70	Jamie Garcia Mendez	407 N. Wood St	Ferris	TX	75125
71	Western Lills LTD/FWH c/o Patricia Snodgrass	3607 Pebble Beach Dr	Farmers Branch	TX	75234
72	David Barnes, Jr.	PO Box 38	Ferris	TX	75125
73	Carmen Banks	PO Box 103	Ferris	TX	75125-0103
74	Isidro & Yolanda Moreno	512 W 1 <sup>st</sup> St	Ferris	TX	75125-0623
75	T. J. Sims	4225 Alicia Ln	Balch Springs	TX	75180-3401
76	Martin Mendez & Maria Jesus Mendez Hernandez	607 A D Mosley St	Ferris	TX	75125-1542

**Skyline Landfill**  
**Land Owners List**  
**(From Appraisal District Records for Dallas and Ellis County – March 26, 2015)**

77	True Vine Missionary Baptist Church	603 W. First St	Ferris	TX	75125
78	Marvin Joe Carey	517 W. First St	Ferris	TX	75125
79	T. L. Wheeler	PO Box 224922	Dallas	TX	75222
80	Alice Izora Hames	505 W. First St	Ferris	TX	75125
81	Henry Bruce	2863 Marjorie Ave	Dallas	TX	75216
82	Humberto & Francisca M. Carbajal	509 Pecan St	Ferris	TX	75125
83	Anna C Olvera	512 A D Mosley St	Ferris	TX	75125-1541
84	Charlie R Grady	518 A D Mosley St	Ferris	TX	75125-1541
85	Gerardo & Francisco Vasquez	524 A D Mosley St	Ferris	TX	75125
86	William & Louis F. Harrison	PO Box 87	Ferris	TX	75125
87	Foris M. & Earl Nichols	2822 Larkspur Ln	Dallas	TX	75233
88	Paul W. Jones	515 N. Main St	Ferris	TX	75125
89	Bud Carter c/o David L. Carter	317 Leads St	Dallas	TX	75203-3144
90	Artiz L. & Monica Murray	2004 Town Pl	Garland	TX	75041-4817
91	Jose & Leticia Hernandez	648 Maple St	Ferris	TX	75125-1551
92	Greater Johnson Chapel AME Church	517 Front St	Ferris	TX	75125
93	Gregorio & Minerva Chavez	616 Neck Rd	Ferris	TX	75125-8872
94	Nancy L. Armstrong	505 Front St	Ferris	TX	75125-1526
95	Gloria D. Washington	PO Box 146	Ferris	TX	75125

**Skyline Landfill**  
**Land Owners List**  
**(From Appraisal District Records for Dallas and Ellis County – March 26, 2015)**

96	Vence Hyder	512 Ferris Rd	Ferris	TX	75125-1102
97	Matiide E Rodriguez	4445 Highland St	Lancaster	TX	75134-1423
98	Church of Christ	509 Ferris St	Ferris	TX	75125
99	Ferris St Church of Christ	509 Ferris Rd	Ferris	TX	75125
100	Aaron E. Edwards, Jr.	610 Meadowridge St	Ferris	TX	75125
101	Lewis Hayes Estate c/o C. McIntosh	1346 Briarbrook Dr	DeSoto	TX	75115-3000
102	Harry Jordon	PO Box 763428	Dallas	TX	75376-3428
103	Ellen Mathis	821 Pecan St	Ferris	TX	75125-1125
104	Willie & Hubert Mozwe L/E, Ellen Mathis, Sherley Banks	829 Pecan St	Ferris	TX	75125-1125
105	Aritz Lee Murray, Jr. & Evelyn Faye Murray	829 Pecan St	Ferris	TX	75125-1125
106	Lawrence & Alice F. Wiley	824 Maple St	Ferris	TX	75125-1128
107	M & M Investments & Partners, Inc.	PO Box 643	Ferris	TX	75125
108	Hilda M. Hernandez	829 Maple St	Ferris	TX	75125-1127
109	Nicolasa Maldonado	702 Oakbrook Ln	Seagoville	TX	75125-0428
110	Ellis County Trustee	PO Box 188	Waxahachie	TX	75168
111	Jeanette Adkins, Joey Ransom, John Ransom, William Ransom	2211 S. Ewing Ave	Dallas	TX	75216-2420
112	Peggy L. Jarvis	713 Mill Creek Rd	Lancaster	TX	75146
113	George Brookins, Jr.	803 Maple St	Ferris	TX	75125-1127
114	William Tittle, Jr. & Lucinda Tittle Hunter	8036 Olusta Dr	Dallas	TX	75217-6779

**Skyline Landfill  
Land Owners List**  
(From Appraisal District Records for Dallas and Ellis County – March 26, 2015)

115	Ana Tafolla	135 N Masters Dr	Dallas	TX	75217-7615
116	Dorothy Brookins	803 Maple St	Ferris	TX	75125-1127
117	Charles Neal & Vivian Zonelle Fulton	313 Mulberry St	Ferris	TX	75125-1803
118	Arturo Delgadillo	1490 Trumbull Rd	Ferris	TX	75125
119	Lourdes Aranjó	607 Front St	Ferris	TX	75125
120	Michael Sims	616 Ferris Rd	Ferris	TX	75125-1104
121	Mt. Rose Primitive Baptist c/o Sharon Sims	PO Box 276	Ferris	TX	75125-1504
122	Opal M. Scott, et al c/o Mazrine Bowie	311 Bluebonnet Ln	Palmer	TX	75152-9791
123	Lilia Ferrer	9513 McClung Ln	Dallas	TX	75217-8604
124	Elmer J. & Wanda F. Holbert	604 Ash St	Ferris	TX	75125
125	Alton Pipkin	704 Front St	Ferris	TX	75125-1553
126	Cecilia Robertson	817 Live Oak St	Wilmer	TX	75172-1506
127	Sonna Monsivaiz & Mary Masek	PO Box 643	Ferris	TX	75125
128	God's Kingdom United Methodist Church c/o Patsy Richards	PO Box 62	Ferris	TX	75125
129	Melissa Sargent	505 Meadowridge St	Ferris	TX	75125-1528
130	Catherine Berry	606 Front St	Ferris	TX	75125-1555
131	Billy Thompson	601 A D Mosley St	Ferris	TX	75125-1542
132	Robert Scott	603 W. First St	Ferris	TX	75125-1506

**Skyline Landfill  
Land Owners List**

(From Appraisal District Records for Dallas and Ellis County – March 26, 2015)

133	Carolina V. Alvarado	607 W. First St	Ferris	TX	75125
134	Maude Oliphant Estate c/o Lucy Mae McDonald	604 Short St	Ferris	TX	75125
135	Macedonia Church of God in Christ	610 A D Mosley St	Ferris	TX	75125-1543
136	Alfredo Ovalle	611 W. First St	Ferris	TX	75125-1506
137	Mable Murray Estate c/o Ruth Scott	603 W. First St	Ferris	TX	75125-1506
138	Juan & Maria Mendez	411 N. Dallas St	Palmer	TX	75152-9687
139	Datrelle D. Black	708 A D Mosley St	Ferris	TX	75125
140	Easter F Richard et al	708 A D Mosley St	Ferris	TX	75125-1545
141	James Howard c/o D McKinney	2519 Club Terrace Dr	Dallas	TX	75237-2707
142	T. L. Reagor	PO Box 592	Ferris	TX	75125-0592
143	Benon Pipkin	PO Box 29	Ferris	TX	75125
144	Mary Patricia Sands	609 Ash St	Ferris	TX	75125-1514
145	Earnie B & Shryl D Scroggins	515 Luciano Ct	Grand Prairie	TX	75052
146	Efrain Franco & Maria Gomez	106 Hurst Cir	Ferris	TX	75125-9791
147	Ferris Memorial Parks, Inc.	PO Box 292	Ferris	TX	75125-0292
148	Ferris Memorial Park, Inc.	120 Magnolia St	Ferris	TX	75125-2309
149	Sandra Johnson	541 Ewing St	Ferris	TX	75125-1524
150	Denise Moore	533 Ewing St	Ferris	TX	75125-1524
151	Juliet D. Rouwtt	529 Ewing St	Ferris	TX	75125-1524

**Skyline Landfill  
Land Owners List**

(From Appraisal District Records for Dallas and Ellis County – March 26, 2015)

152	Thurman & Eula Adams	525 Ewing St	Ferris	TX	75125-1524
153	Christal S. & Jose E. Ortiz	2261 84W Hwy	Mexia	TX	76667
154	Ruby Griggs	517 Ewing St	Ferris	TX	75125-1524
155	Carolyn Hollywood	513 Ewing St	Ferris	TX	75125-1524
156	Grand Homes Irrevocable Spendthrift Trust	PO Box 643	Ferris	TX	75125
157	Mack Troy Williams	505 Ewing St	Ferris	TX	75125-1524
158	Cherry J. McCray	501 Ewing St	Ferris	TX	75125-1524
159	Sherman B. & Nancy L. Swafford	432 Meadowgate Cir	Ferris	TX	75125-1402
160	Betty J. Parks	428 Meadowgate Cir	Ferris	TX	75125-1402
161	Adam Arevalo	424 Meadowgate Cir	Ferris	TX	75125-1402
162	Norantha M. Pates	311 A Avenue	Ferris	TX	75125-1612
163	Rodney K. & Marilyn Kaye Sewell	412 Meadowgate Cir	Ferris	TX	75125-1402
164	Samuel L. Green	408 Meadowgate Cir	Ferris	TX	75125-1402
165	Dewayne B. Casper	403 Meadowgate Cir	Ferris	TX	75125-1401
166	Travis L. White	407 Meadowgate Cir	Ferris	TX	75125-1401
167	R. V. Proctor	411 Meadowgate Cir	Ferris	TX	75125-1401
168	Octavio & Blanca Mendez	415 Meadowgate Cir	Ferris	TX	75125-1401
169	Juanita Mercado	PO Box 123	Ferris	TX	75125-0123
170	Jose C. Gutierrez	423 Meadowgate Cir	Ferris	TX	75125-1401

**Skyline Landfill  
Land Owners List**  
(From Appraisal District Records for Dallas and Ellis County – March 26, 2015)

171	Reverse Mortgage Solutions Inc.	2727 Spring Creek Dr	Spring	TX	77373	
172	Gladys Y. Nunez	PO Box 15	Ferris	TX	75125	
173	Javier Dyal	432 Yellow Jacket Dr	Ferris	TX	75125	
174	Maria Duran Galindo	428 Yellow Jacket Dr	Ferris	TX	75125-1416	
175	Paul H. Coumpy	424 Yellow Jacket Dr	Ferris	TX	75125-1416	
176	R. L. Hooper	420 Yellow Jacket Dr	Ferris	TX	75125-1416	
177	Jerry & Alice Holloway	209 N Laramie Cir	Pilot Point	TX	76258-2607	
178	Shepherd Place Homes, Inc.	620 Rowlett Rd	Garland	TX	75043-3703	
179	Charles E. Miner	408 Yellow Jacket Dr	Ferris	TX	75125-1416	
180	Robert Earl Davis, Jr.	404 Yellow Jacket Dr	Ferris	TX	75125-1416	
181	Bobby & Lois Johnson	1009 Western Hills Dr	Ferris	TX	75125-1411	
182	Deborah A. Jarvis	1021 Western Hills Dr	Ferris	TX	75125-1411	
183	Deacon Shields	2813 Rio Grande St	Austin	TX	78705	
184	Jessie C. Garza	1901 Risinger Rd	Ferris	TX	75125-8339	
185	Gloria M. Coumpy	1037 Western Hills Dr	Ferris	TX	75125-1411	
186	Maribel & Roberto Villa	1041 Western Hills Dr	Ferris	TX	75125-1411	
187	James & Monique Foster	1045 Western Hills Dr	Ferris	TX	75125-1411	
188	Darlene Palmer	1049 Western Hills Dr	Ferris	TX	75125-1411	
189	Harvey Cox, Sr. & Odessa H. Cox	118 Clark St	Ferris	TX	75125-1411	

**Skyline Landfill  
Land Owners List**  
(From Appraisal District Records for Dallas and Ellis County – March 26, 2015)

	8540 FM 879	Palmer	TX	75152-9126
190	Kenny Caldwell & Ronny Caldwell c/o G. R. Caldwell			
191	Julio & Celia D. Morales	Ferris	TX	75125-1411
192	Jessie B. Elverton	Ferris	TX	75125-1411
193	Glen A. Bailey	Ferris	TX	75125-1411
194	Michael Pace & Lesia Jackson	Ferris	TX	75125-1406
195	Gilberto & Frances Gonzales	Ferris	TX	75125-1405
196	Ladd Vien	Waxahachie	TX	75165-2588
197	Marcus Moreno	Ferris	TX	75125-1405
198	Freddie Mae Kibble	Ferris	TX	75125-0846
199	SHCR Investors LLC	Dallas	TX	75225-6300
200	Shaw Creek Ranch 1B LP	Dallas	TX	75205-2726
201	Billy F. & Carmalla Haywood	Palmer	TX	75152-8232
202	Carl W. & Neta H. McAfee	Missoula	MT	59803-1630
203	North TX District Council of The Assembly of God Church	Waxahachie	TX	75168-0838
204	James & Virginia L. Toomey	Ferris	TX	75125-2309
205	Hector Rojas	Lancaster	TX	75146
206	Blanca Borrego	Arlington	TX	76015-6193
207	Arcadio Mendez	Ferris	TX	75125-2708
208	Mattie B. Evans	Dallas	TX	75232-4405



**Skyline Landfill**  
**Land Owners List**  
**(From Appraisal District Records for Dallas and Ellis County – March 26, 2015)**

209	Rubisela Chavez-Garcia	516 W 1st St	Ferris	TX	75125
210	J. Cruz & Raquel Garcia	711 Ferris Rd	Ferris	TX	75125
211	Maria F. Diaz	1939 Gaylord	Dallas	TX	75217
212	Nextlots 2 LLC	PO Box 865	Lancaster	TX	75146-0865
213	Marven W Brown	PO Box 140453	Broken Arrow	OK	74014-0004
214	Sharon M Scott	101 Oakwood Ln	Red Oak	TX	75154-1417
215	Carol J. Wright	PO Box 226	Ferris	TX	75125-0226
216	GMS Investments	1547 Brookview Dr	Lancaster	TX	75146-9734
217	Delphine Pringle	412 Summertree	Hutchins	TX	75141
218	Steven G Christian	134 Youngblood Rd	Waxahachie	TX	75165-8973
219	Gehu & Teresa Gonzalez	989 Bluffsprings	Ferris	TX	75125
220	Edna Mae Cantfield c/o Mitchell L. Pinkard	6231 Kansas Ave	Omaha	NE	68104-1129
221	Dennis E & Tracey D Curtis	2618 Sleepy Hollow Ln	Lancaster	TX	75146-5900

Mineral Interest and Ownership

The Dallas County Appraisal District (DCAD) records were searched for all mineral interest ownership under the facility. No mineral interest ownership information was available within DCAD for the facility. The Ellis County Appraisal District (EAD) records were searched for all mineral interest ownership under the facility. No mineral interest ownership information was available within EAD for the facility.

J:\101\01\120\Part 1\IB.1-LandOwners-R3-15.dwg Layout: 1B.1 User: scundiff

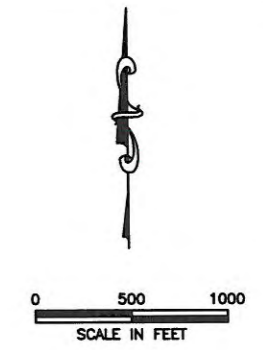

- LEGEND**
- PERMIT BOUNDARY
  - - - - EXISTING LANDFILL FOOTPRINT
  - - - - PROPOSED LANDFILL FOOTPRINT
  - COUNTY LINE
  - ① LAND OWNERSHIP IDENTIFICATION
  - LAND OWNED BY WASTE MANAGEMENT

- NOTES:**
1. REFER TO LAND OWNERS LIST ON PAGE IB-1 THROUGH IB-12 FOR ADJACENT LAND OWNER LIST.
  2. ADJACENT LAND OWNERS IN DALLAS COUNTY BASED ON DALLAS COUNTY APPRAISAL DISTRICT RECORDS DOWNLOADED FROM DCAD WEBSITE ON MARCH 26, 2015. ADJACENT LAND OWNERS IN ELLIS COUNTY PROVIDED BY ELLIS COUNTY APPRAISAL DISTRICT RECORDS, UPDATED MARCH 26, 2015.
  3. LAND OWNERS HAVE BEEN IDENTIFIED ADJACENT TO AND WITHIN 1/4 MILE OF THE PERMIT BOUNDARY.



**LAND OWNERSHIP MAP**  
**WASTE MANAGEMENT OF TEXAS, INC.**  
**SKYLINE LANDFILL**  
**MAJOR PERMIT AMENDMENT**

**BIGGS & MATHEWS**  
 ENVIRONMENTAL  
 CONSULTING ENGINEERS  
 MANSFIELD • WICHITA FALLS  
 817-563-1144

ISSUED FOR PERMITTING PURPOSES ONLY

REVISIONS							TSPE FIRM NO. F-256	TBPG FIRM NO. 50222
1	3/15	SUPPLEMENTAL RESPONSE	SRC	KJW	KJW	KJW	DSN. KJW DATE : 04/12	FIGURE
REV	DATE	DESCRIPTION	DWN BY	DES BY	CHK BY	APP BY	DWN. SRC SCALE : GRAPHIC	IB.1
							CHK. KJW DWG : IB.1-LandOwners-R3-15.dwg	

32°32'30"

32°32'30"

96°40"

DALLAS COUNTY  
 ELLIS COUNTY

1/4 MILE RADIUS

NORTH CENTRAL STREET (U.S. 75)

INTERSTATE HIGHWAY 45

SEE DRAWING 1B.2

SEE DRAWING 1B.3

J:\101\01\120\Part 1\IB.1-LandOwners-R3-15.dwg Layout: 1B.2 User: scundiff

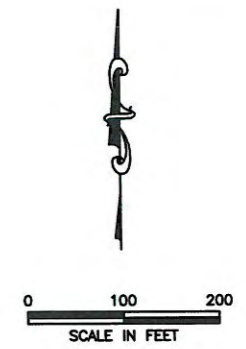
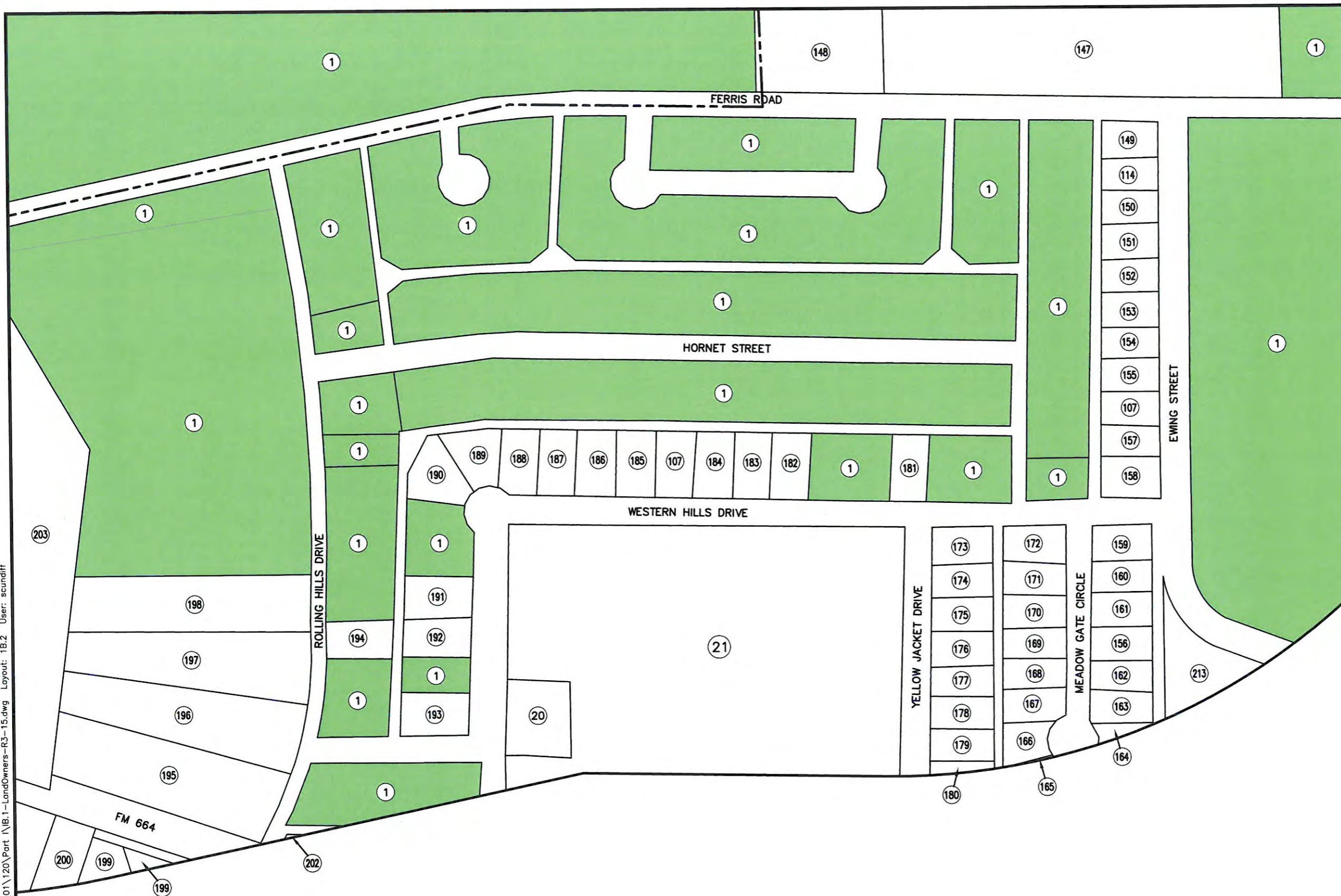

- LEGEND**
- PERMIT BOUNDARY
  - ① LAND OWNERSHIP IDENTIFICATION
  - LAND OWNED BY WASTE MANAGEMENT

- NOTES:**
1. REFER TO LAND OWNERS LIST ON PAGE IB-1 THROUGH IB-12 FOR ADJACENT LAND OWNER LIST.
  2. ADJACENT LAND OWNERS IN DALLAS COUNTY BASED ON DALLAS COUNTY APPRAISAL DISTRICT RECORDS DOWNLOADED FROM DCAD WEBSITE ON MARCH 26, 2015. ADJACENT LAND OWNERS IN ELLIS COUNTY PROVIDED BY ELLIS COUNTY APPRAISAL DISTRICT RECORDS, UPDATED MARCH 26, 2015.
  3. LAND OWNERS HAVE BEEN IDENTIFIED ADJACENT TO AND WITHIN 1/4 MILE OF THE PERMIT BOUNDARY.



**LAND OWNERSHIP MAP**

**WASTE MANAGEMENT OF TEXAS, INC.**  
**SKYLINE LANDFILL**  
**MAJOR PERMIT AMENDMENT**

**BIGGS & MATHEWS**  
 ENVIRONMENTAL  
 CONSULTING ENGINEERS  
 MANSFIELD • WICHITA FALLS  
 817-563-1144

ISSUED FOR PERMITTING PURPOSES ONLY

REVISIONS							TBPE FIRM NO. F-256	TPPG FIRM NO. 50222
1	3/15	SUPPLEMENTAL RESPONSE	SRC	KJW	KJW	KJW	DSN. KJW DATE : 04/12	FIGURE
REV	DATE	DESCRIPTION	DWN BY	DES BY	CHK BY	APP BY	DWN. SRC SCALE : GRAPHIC	IB.2
							CHK. KJW DWG : IB.1-LandOwners-R3-15.dwg	

J:\101\101\120\Part 1\IB.1-LandOwners-R3-15.dwg Layout: 1B.3 User: scundiff

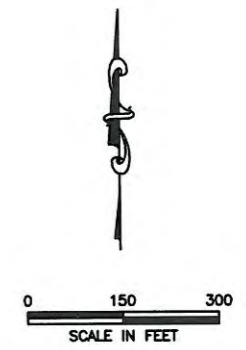

- LEGEND**
- PERMIT BOUNDARY
  - EXISTING LANDFILL FOOTPRINT
  - PROPOSED LANDFILL FOOTPRINT
  - LAND OWNERSHIP IDENTIFICATION
  - LAND OWNED BY WASTE MANAGEMENT

- NOTES:**
1. REFER TO LAND OWNERS LIST ON PAGE IB-1 THROUGH IB-12 FOR ADJACENT LAND OWNER LIST.
  2. ADJACENT LAND OWNERS IN DALLAS COUNTY BASED ON DALLAS COUNTY APPRAISAL DISTRICT RECORDS DOWNLOADED FROM DCAD WEBSITE ON MARCH 26, 2015. ADJACENT LAND OWNERS IN ELLIS COUNTY PROVIDED BY ELLIS COUNTY APPRAISAL DISTRICT RECORDS, UPDATED MARCH 26, 2015.
  3. LAND OWNERS HAVE BEEN IDENTIFIED ADJACENT TO AND WITHIN 1/4 MILE OF THE PERMIT BOUNDARY.



**LAND OWNERSHIP MAP**  
**WASTE MANAGEMENT OF TEXAS, INC.**  
**SKYLINE LANDFILL**  
**MAJOR PERMIT AMENDMENT**

**BIGGS & MATHEWS**  
**ENVIRONMENTAL**  
**CONSULTING ENGINEERS**  
 MANSFIELD • WICHITA FALLS  
 817-563-1144

ISSUED FOR PERMITTING PURPOSES ONLY

REVISIONS							TBPE FIRM NO. F-256	TBPG FIRM NO. 50222
1	3/15	SUPPLEMENTAL RESPONSE	SRC	KJW	KJW	KJW	DSN. KJW	DATE : 04/12
							DWN. SRC	SCALE : GRAPHIC
REV	DATE	DESCRIPTION	DWN BY	DES BY	CHK BY	APP BY	CHK. KJW	DWG : IB.1-LandOwners-R3-15.dwg

FIGURE  
**IB.3**